

PASSENGER SEATS - MAINTENANCE PRACTICES

1. General

- A. Maintenance practice describes various passenger seat configurations and provides removal and installation procedures for various seating types.
- B. For various passenger seating configurations, refer to Figure 201.

2. Description

- A. Utility Passenger Seats (Model 208 and 208B Passenger) (Refer to Figure 202).
 - (1) Optional utility seats are constructed of canvas on tubular frames, and are positioned behind each other (four seats on each side of the airplane). Seats may be folded into a compact space for stowage in the aft baggage compartment when not in use. When desired, the seats can be unfolded and installed in the passenger area. The seats are fixed position and nonadjustable. Seat belts and shoulder harness are attached to each seat.
- B. Commuter Passenger Seats (Model 208 and 208B Passenger) (Refer to Figure 203).
 - (1) Optional commuter seats are constructed of tubular frames with foam padding and fabric covering. Seats are fixed position with nonadjustable backs and may be either single passenger or two-place passenger types. The seats are easily removed to facilitate cargo hauling. All seats are equipped with seat belts and shoulder harnesses attached to seat frames.
 - (a) Seats with manual adjust shoulder harness restraints are installed in Airplanes 20800001 thru 20800403, and in Airplanes 208B0001 thru 208B1231.
 - (b) Seats with inertial reel automatic adjust shoulder harness 3-point restraints are installed in Airplanes 20800404 and On, and in Airplanes 208B1232 and On.
 - (2) Model 208B airplanes with 10-Place and 13-Place Commuter Passenger Seating may install left seats on right side of airplane and right seats on left side of airplane to provide additional space between seat and sidewall.
- C. Passenger Seats (14-Place Model 208 and 208B Passenger) (Refer to Figure 204).

WARNING: The 14-place seating provides increased passenger capacity to support certain international commuter operations. Utilization is limited to those nations where approval is received. The United States does not authorize more than nine passenger seats (excluding crew) under Provisions of 14 CFR 23.1.

- (1) Optional 14-place seating arrangement utilizes commuter seating, as well as a three-place, fixed- position bench seat, located on the raised floorboard area immediately aft of passenger and cargo doors. The seat is easily removable to facilitate cargo hauling. Seat belts and shoulder harnesses, furnished with seats, attach to the airplane structure.

3. Utility Passenger Seats and Restraint System Removal/Installation

- A. Remove Seats (Refer to Figure 202).
 - (1) Raise lock on each seat leg attach fitting (four total).
 - (2) Move seat forward or aft slightly until attach fittings are aligned with openings in seat track.
 - (3) Lift seat out.
- B. Install Seats (Refer to Figure 202).
 - (1) Position seat on seat track and insert attach fittings in seat track openings.
 - (2) Move seat forward or aft until locks are aligned with opening in seat track.
 - WARNING: It is extremely important that passenger seat locks are securely engaged. Acceleration and deceleration could permit seat to become disengaged from rails, creating a hazardous situation, especially during takeoff and landing.**
 - (3) Push locks down into seat track openings. Ensure locks are fully engaged in seat track.
- C. Remove Seat Belts and Shoulder Harness (Refer to Figure 202).
 - (1) Remove bolts, washers and nuts attaching ends of seat belt to seat frame.
 - (2) Remove bolt, washer and nut attaching shoulder harness to top of seat back frame.
 - (3) Remove seat belt and shoulder harness as a unit.
- D. Install Seat Belts and Shoulder Harness (Refer to Figure 202).

- (1) Position seat belt and shoulder harness on seat. Ensure correct side is up and no twists are present in belt.
- (2) Attach ends of seat belt and shoulder harness to seat frame and to top of seat back frame using bolts, washers and nuts.
- (3) Ensure all hardware is tight.

E. Utility Seat Folding/Unfolding and Removal/Installation (Refer to Figure 202).

- (1) Fold and remove utility seat.
 - (a) Pull pins out of each seat back brace and fold seat forward.
 - (b) Pull five pins out of leg braces and fold all legs toward center of seat.
 - (c) Remove and stow seat in aft cargo compartment. Refer to Remove Seats, located in this section.
- (2) Install and unfold utility seat.
 - (a) Position utility seat in airplane and unfold legs.
 - (b) Insert pins in each seat back bracket.
 - (c) Insert five pins in leg braces.
 - (d) Ensure all pins are inserted correctly.
 - (e) Install seats in airplane. Refer to Install Seats, located in this section.

4. Commuter Passenger Seats and Restraint System Removal/Installation

NOTE: Removal/Installation procedures are typical for both the single passenger and two-place passenger seats.

NOTE: Model 208B airplanes with 10-Place and 13-Place Commuter Passenger Seating may install left seats on right side of airplane and right seats on left side of airplane to provide additional space between seat and sidewall.

A. Remove Seats (Refer to Figure 203).

- (1) Raise seat track lock on each attach fitting.
- (2) Move seat forward or aft slightly until track attach fittings are lined up with openings in seat.
- (3) Lift seat out.

B. Install Seats (Refer to Figure 203).

- (1) Position seat on seat track and insert attach fittings in seat track openings.
- (2) Move seat forward or aft until locks are lined up with opening in seat track.

WARNING: It is extremely important that passenger seat locks are securely engaged. Acceleration and deceleration could permit seat to become disengaged from rails and create a hazardous situation, especially during takeoff and landing.

- (3) Push locks down into seat track openings. Ensure locks are fully engaged in seat track.

5. Restraint System Removal and Installation

A. Remove and Install the Manual Adjust Seat Belt and Shoulder Harness (Refer to Figure 203).

- (1) Remove the manual adjust seat belt/shoulder harness.
 - (a) Remove the bolts, washers, spacers and nuts that connect the attach stirrups to the frame.
 - (b) Remove the screws that attach the seat panel to the frame and remove the seat panel.
 - (c) Remove the headrest and the shoulder harness stirrup.
- (2) Install the manual adjust seat belt and shoulder harness.

NOTE: The seat belt and shoulder harness must not be twisted when you install them.

- (a) Install the shoulder harness stirrup and the headrest to the seat frame.
- (b) Attach the seat panel to the frame with screws.
- (c) Install the attach stirrups to the seat frame with bolts, washers, spacers and nuts.

B. Remove and Install the Inertial Reel Automatic Adjust Seat Belt and Shoulder Harness (Refer to Figure 203).

- (1) Remove the Inertial Reel Automatic Adjust Seat Belt/Shoulder Harness.

- (a) Remove and discard the bolts, washers, spacers, and nuts that attach the lap belt stirrups to both sides of the frame.
 - (b) Remove the lap belt from the seat frame.
 - (c) Remove and keep the screws that attach the seat back panel to the seat back frame and remove seat back panel.
 - (d) Remove the webbing from the web guide at the top of the seat back.
 - (e) Remove the inertial reel hardware and the inertial reel from the seat back. Discard the hardware.
- (2) Install the Inertial Reel Automatic Adjust Seat Belt/Shoulder Harness.

NOTE: The seat belt and the shoulder harness must not be twisted when you install them.

- (a) Install the inertial reel to the seat back with new hardware.
- (b) Install the webbing through the web guide at the top of the seat back.
- (c) Install the seat back panel to the seat back frame with the kept screws.
- (d) Install the lap belt connectors to both sides of the seat frame with new hardware.

6. Three-Place Bench Seat and Restraint System Removal/Installation

NOTE: A 3-place bench seat is installed in the 14-Place passenger airplane.

- A. Remove Bench Seats (Refer to Figure 204).
 - (1) Grasp front edge of lower cushion and lift to disengage fabric fastener. Remove cushion.
 - (2) Lift and remove seat back.
- B. Install Bench Seats (Refer to Figure 204).
 - (1) Locate lower seat cushion on raised floorboard area and press firmly to floor to fully engage fabric fastener.
 - (2) Place seat belts across lower cushion.
 - (3) Wedge seat back between lower cushion and aft cabin partition.
- C. Remove Seat Belts and Shoulder Harness (Refer to Figure 204).
 - (1) Disconnect seat belt assembly quick-release stirrups from inboard and outboard attach brackets located on floor.
 - (2) Remove bolt and spacer attaching shoulder harness assembly to aft partition.
- D. Install Seat Belts and Shoulder Harness (Refer to Figure 204).
 - (1) Attach seat belt assembly quick-release stirrups to inboard and outboard attach brackets located on floor.
 - (2) Position shoulder harness stirrups to aft partition and secure using bolt and spacer.

Figure 201 : Sheet 1 : Passenger Seat Configurations

A22643

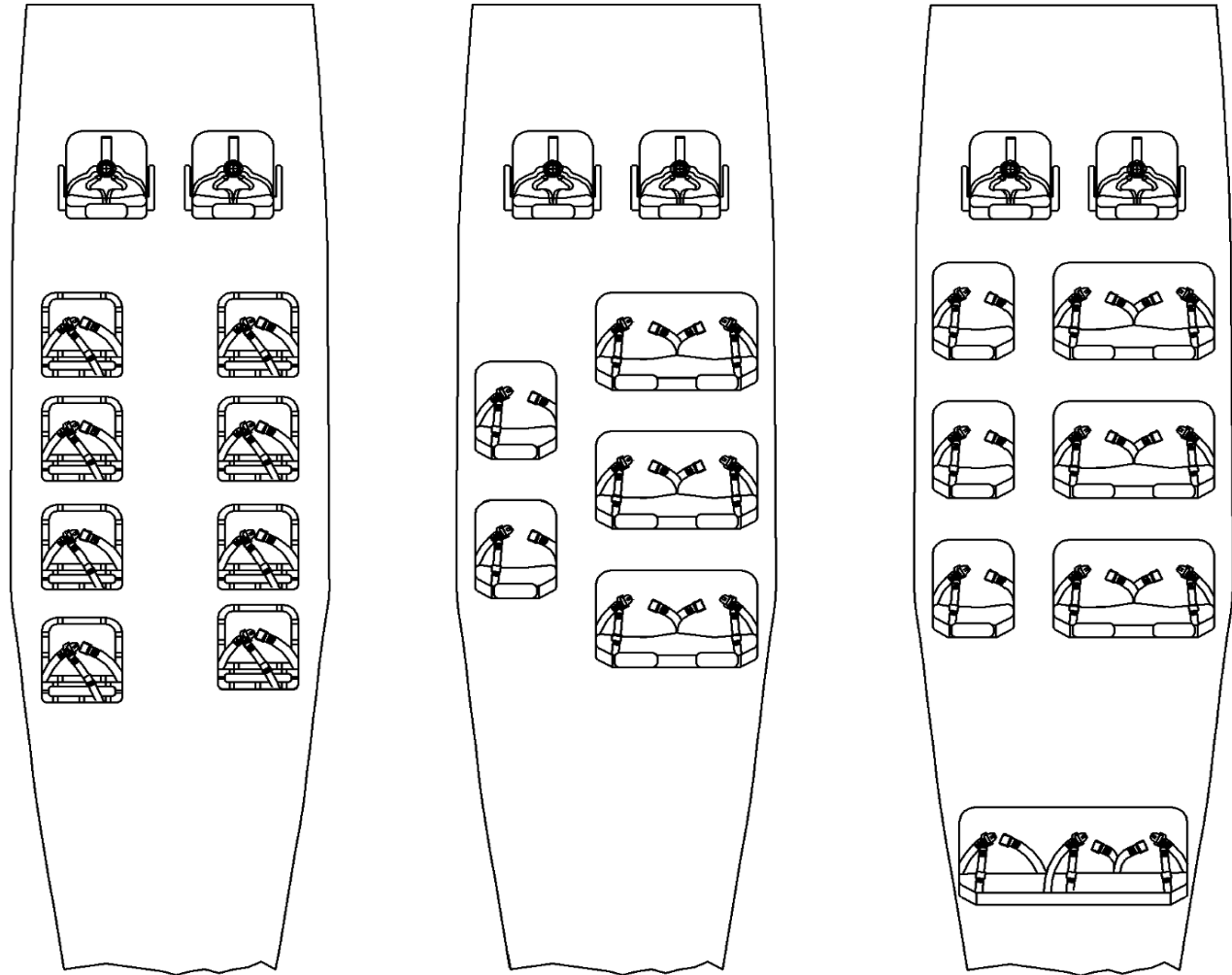

OPTIONAL
UTILITY

STANDARD
COMMUTER

14-PLACE
SEATING

MODEL 208 ONLY

2619T2027
2619T2028
2619T2029

Figure 201 : Sheet 2 : Passenger Seat Configurations

A22641

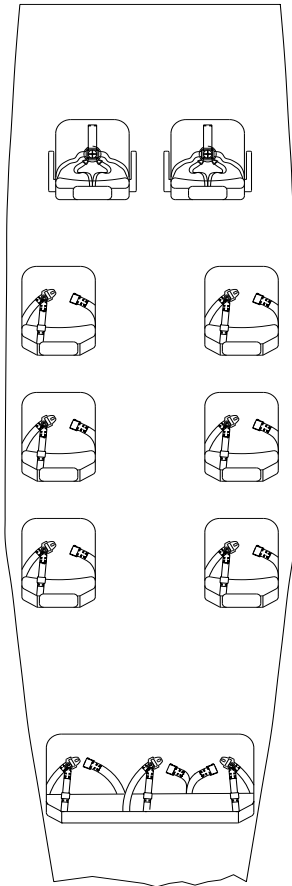

11-PLACE SEATING
COMMUTER (UK)

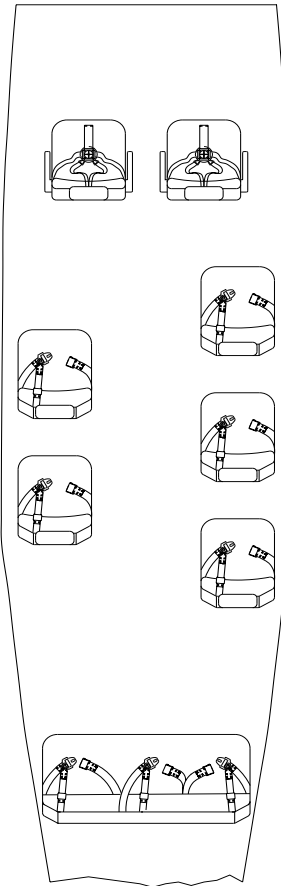

10-PLACE SEATING

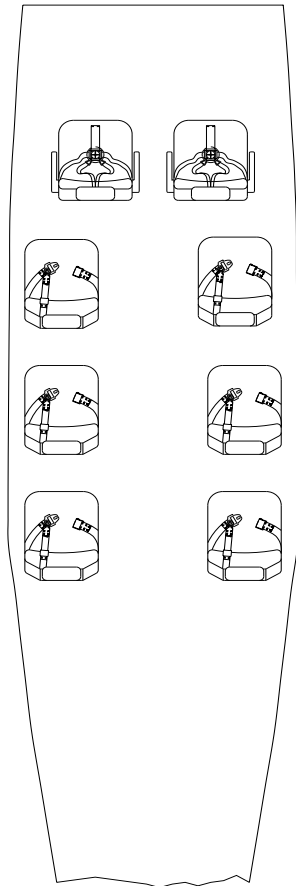

8-PLACE SEATING
COMMUTER

MODEL 208 ONLY

2619T1091
2619T1092
2619T1159

Figure 201 : Sheet 3 : Passenger Seat Configurations

A22646

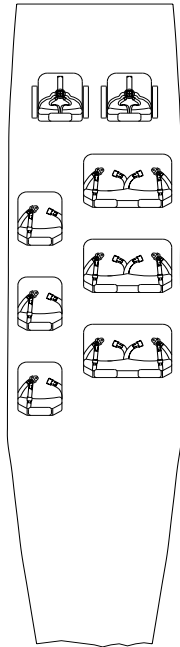

11-PLACE SEATING
COMMUTER

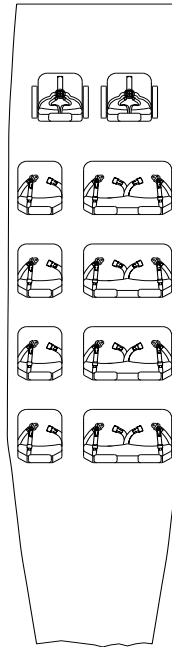

14-PLACE SEATING
COMMUTER (UK)

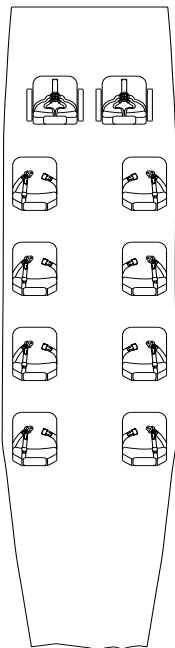

10-PLACE SEATING
COMMUTER
(NOTE)

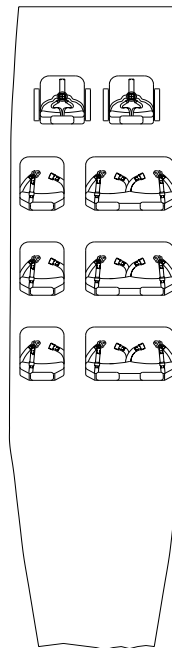

11-PLACE SEATING
COMMUTER

NOTE: PERMISSIBLE TO INSTALL LEFT SEAT ON RIGHT SIDE OF AIRPLANE AND RIGHT SEAT ON LEFT SIDE OF AIRPLANE

2619T1093
2619T1094
2619T1095
2619T1158

Figure 201 : Sheet 4 : Passenger Seat Configurations

A22651

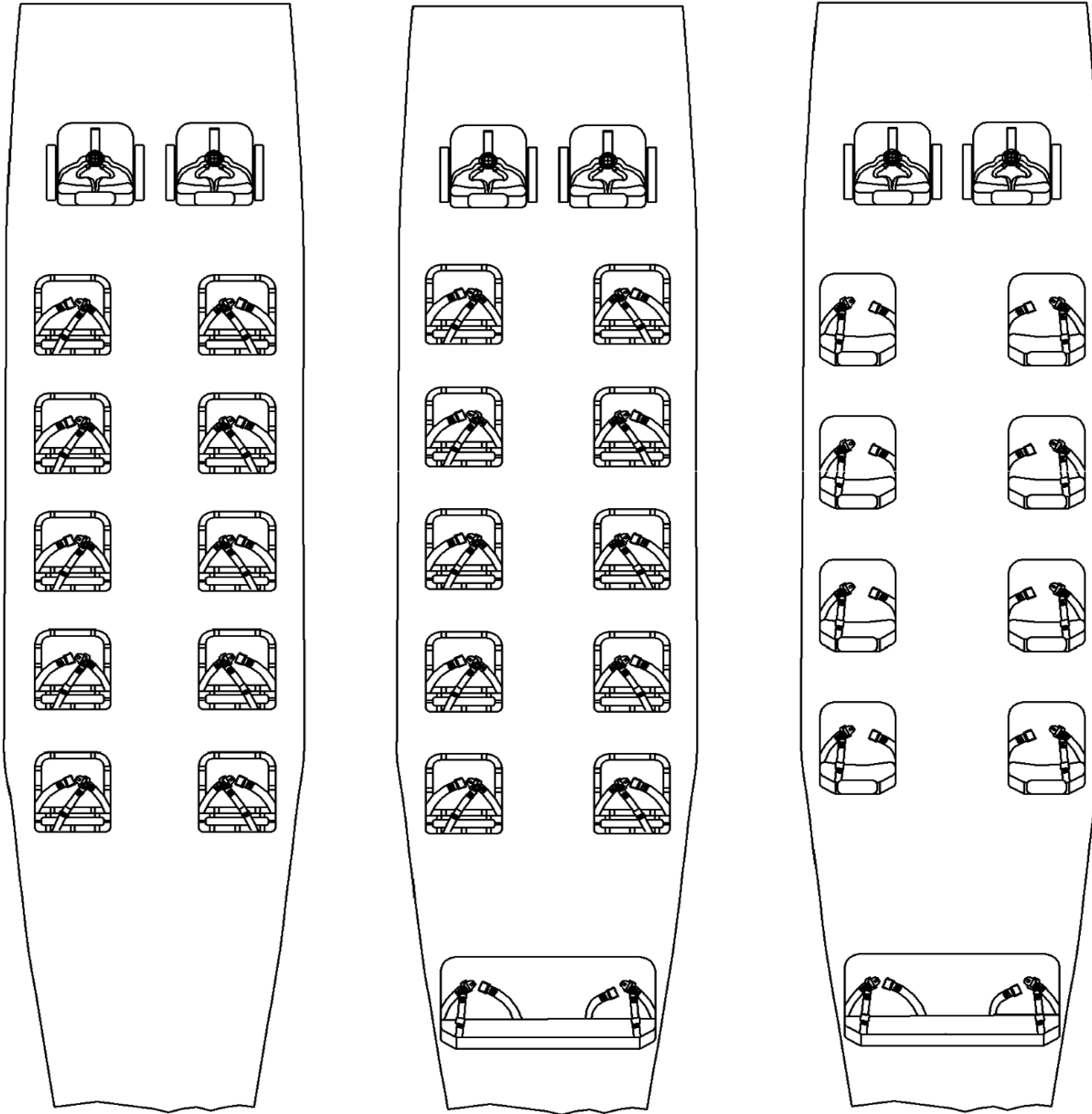

12-PLACE SEATING
STOWABLE (UK)

14-PLACE SEATING
STOWABLE (UK)

12-PLACE SEATING
COMMUTER (UK)

MODEL 208B PASSENGER

2619T1096
2619T1097
2619T1098

Figure 201 : Sheet 5 : Passenger Seat Configurations

A22656

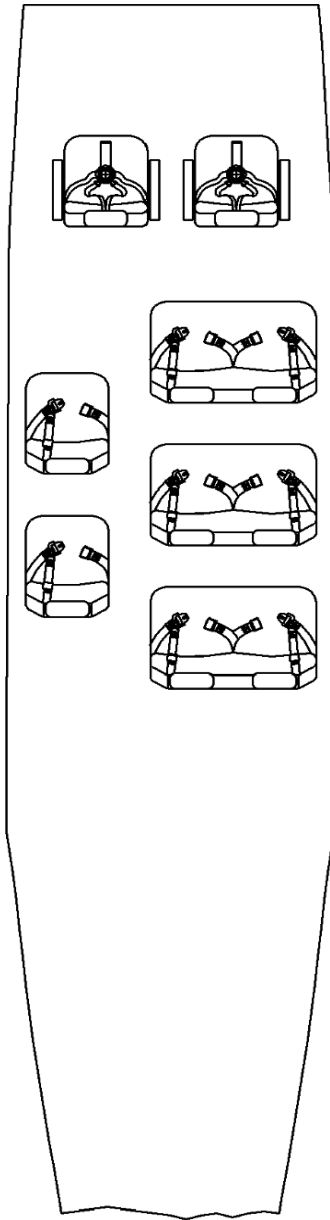

10-PLACE SEATING
COMMUTER
(NOTE)

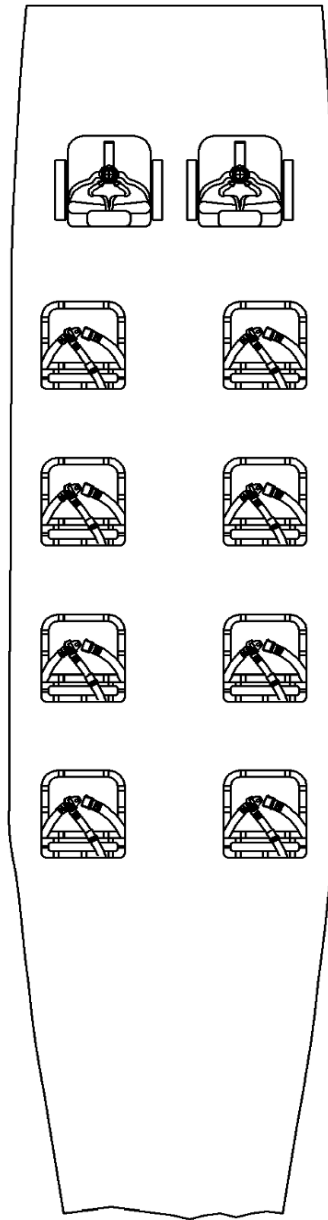

10-PLACE SEATING
STOWABLE

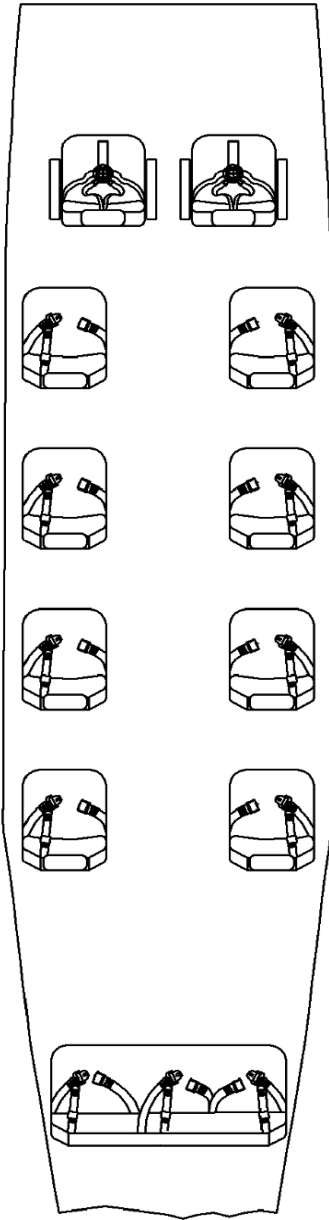

13-PLACE SEATING
COMMUTER
(NOTE)

NOTE: PERMISSIBLE TO INSTALL LEFT SEAT ON
RIGHT SIDE OF AIRPLANE AND RIGHT SEAT
ON LEFT SIDE OF AIRPLANE

MODEL 208B PASSENGER

2619T1099
2619T1100
2619T1140

Figure 202 : Sheet 1 : Optional Utility Seat Installation

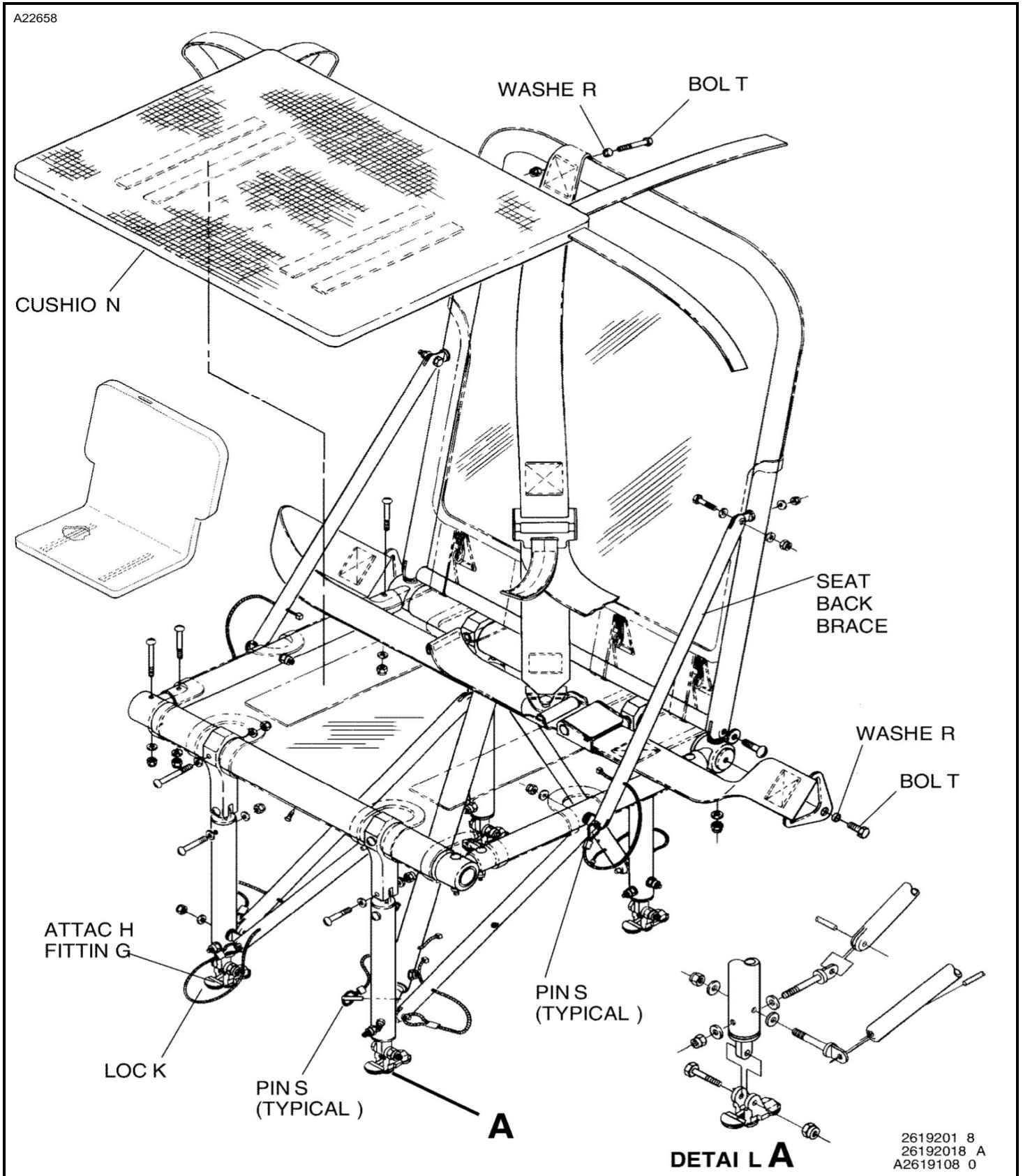

Figure 203 : Sheet 1 : Passenger Commuter Seat Installation

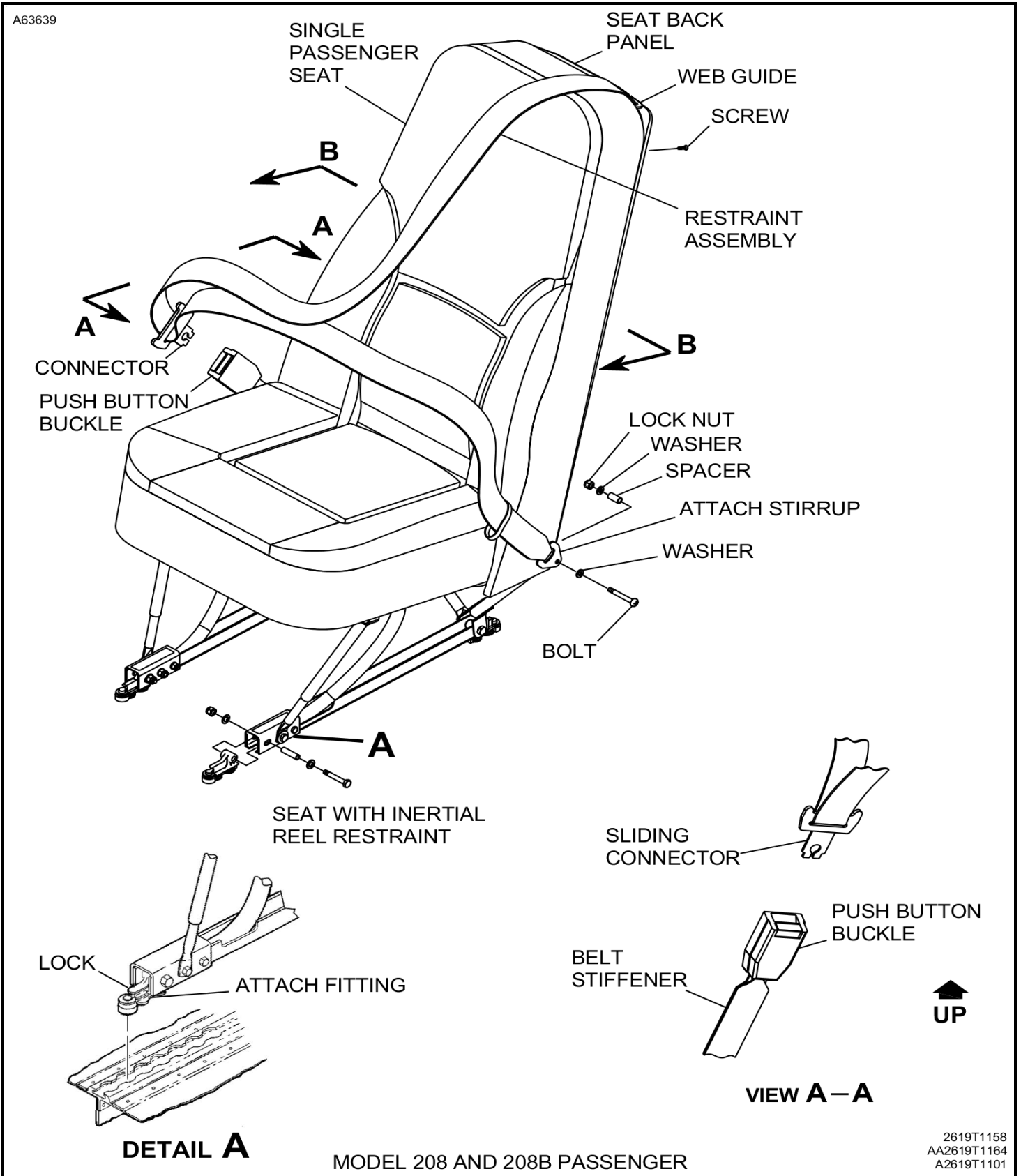

Figure 203 : Sheet 2 : Passenger Commuter Seat Installation

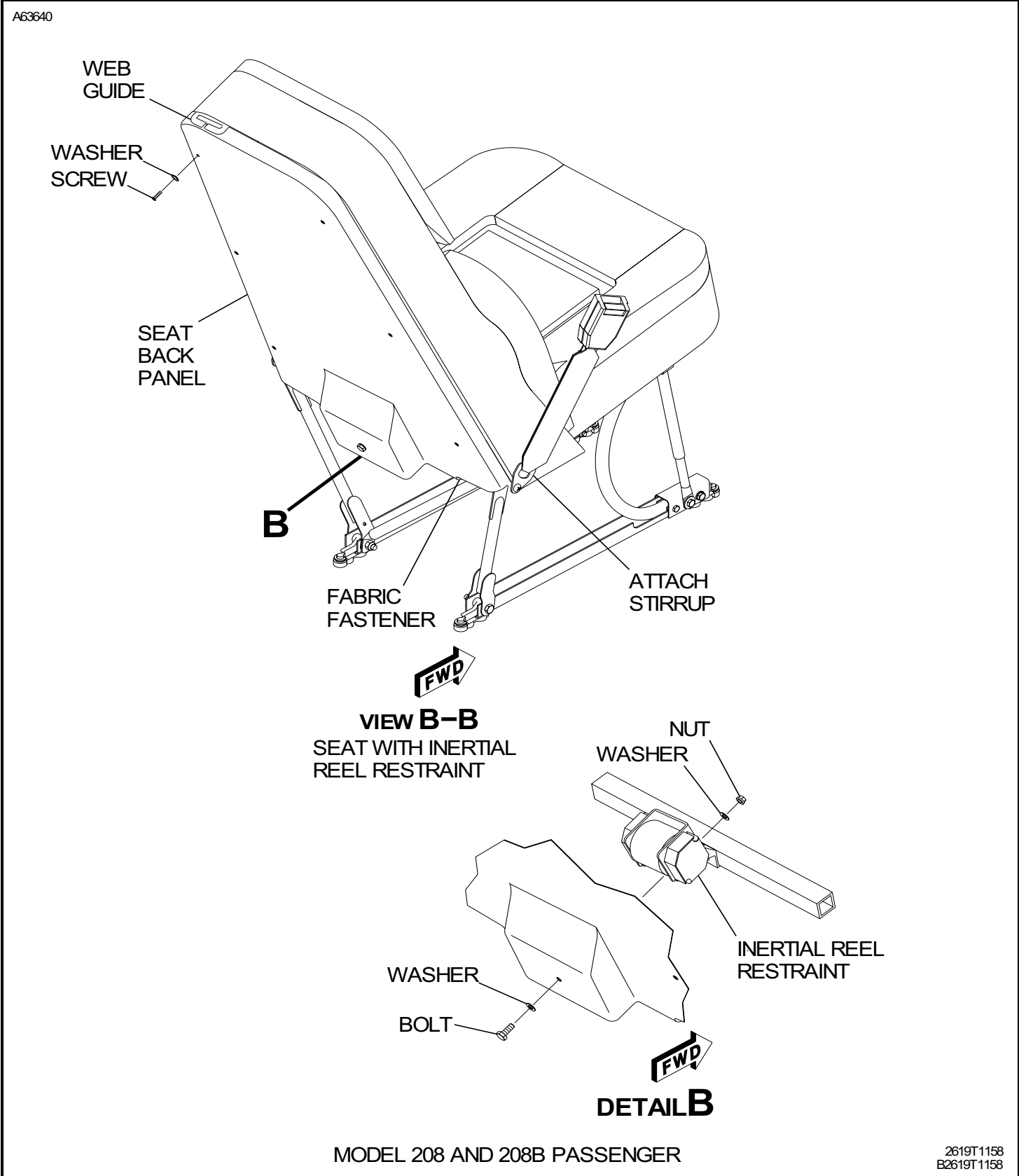
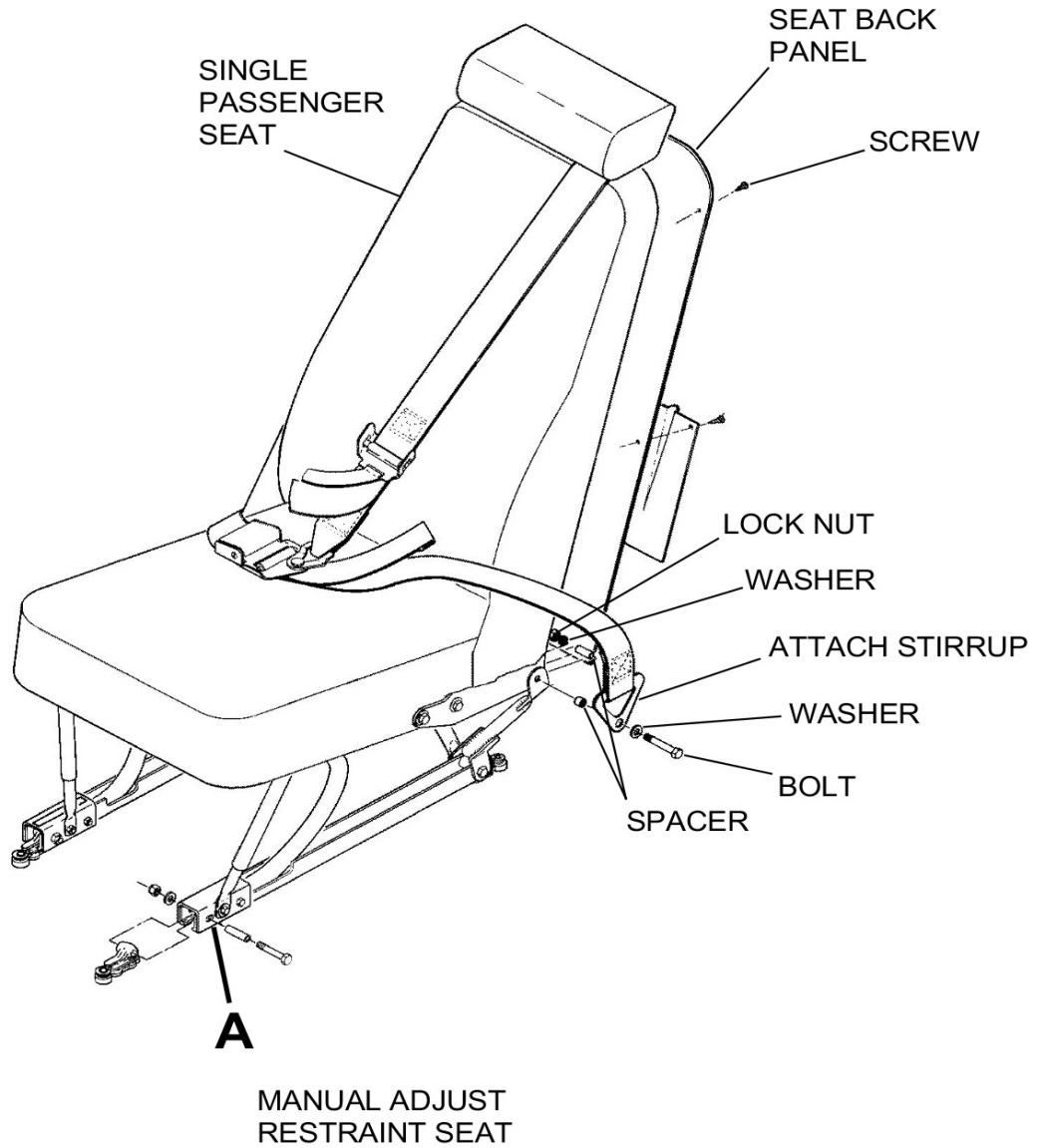

Figure 203 : Sheet 3 : Passenger Commuter Seat Installation

A22662



MODEL 208 AND 208B PASSENGER

2619T1158
B2619T1158

Figure 203 : Sheet 4 : Passenger Commuter Seat Installation

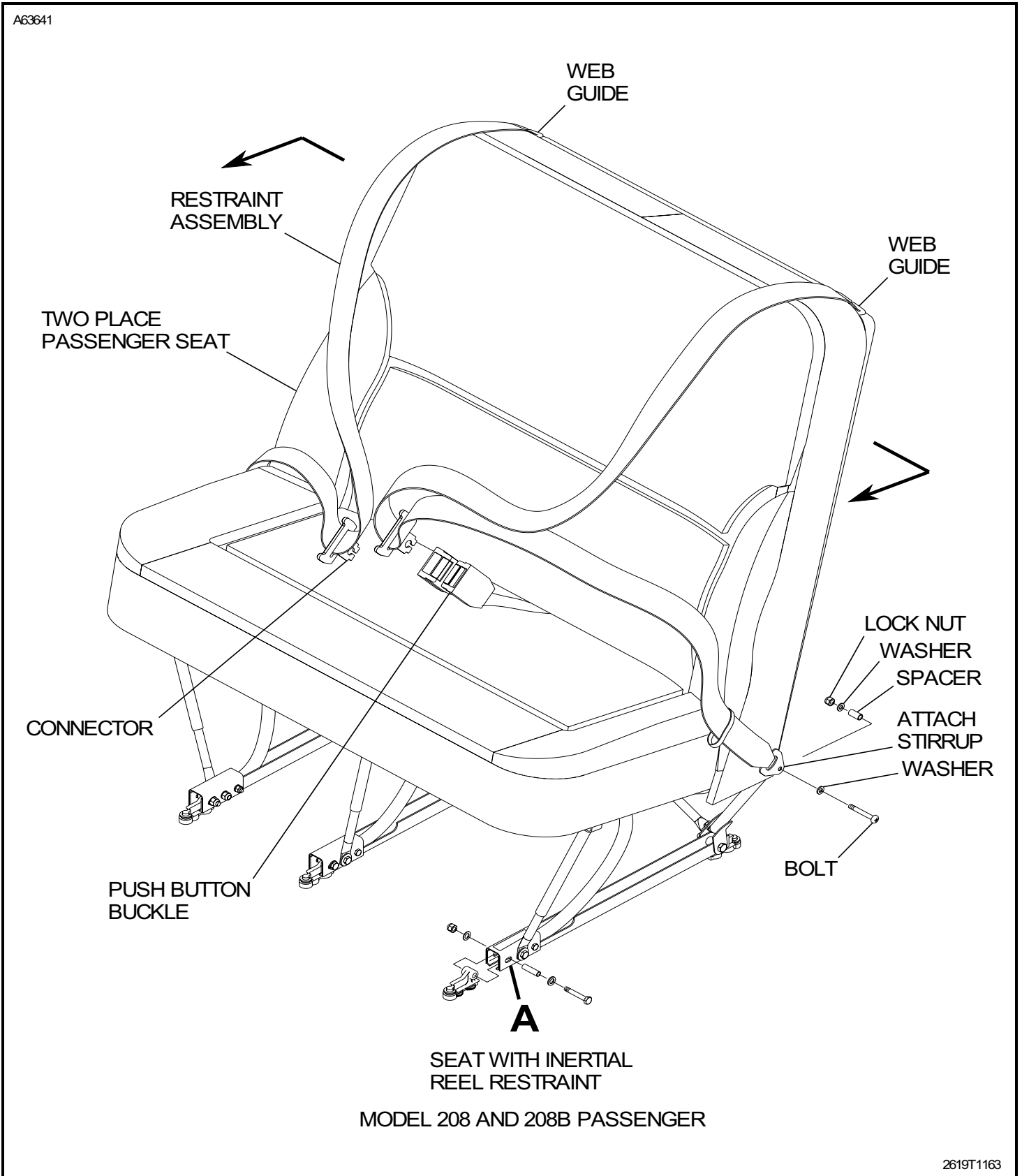

Figure 203 : Sheet 5 : Passenger Commuter Seat Installation

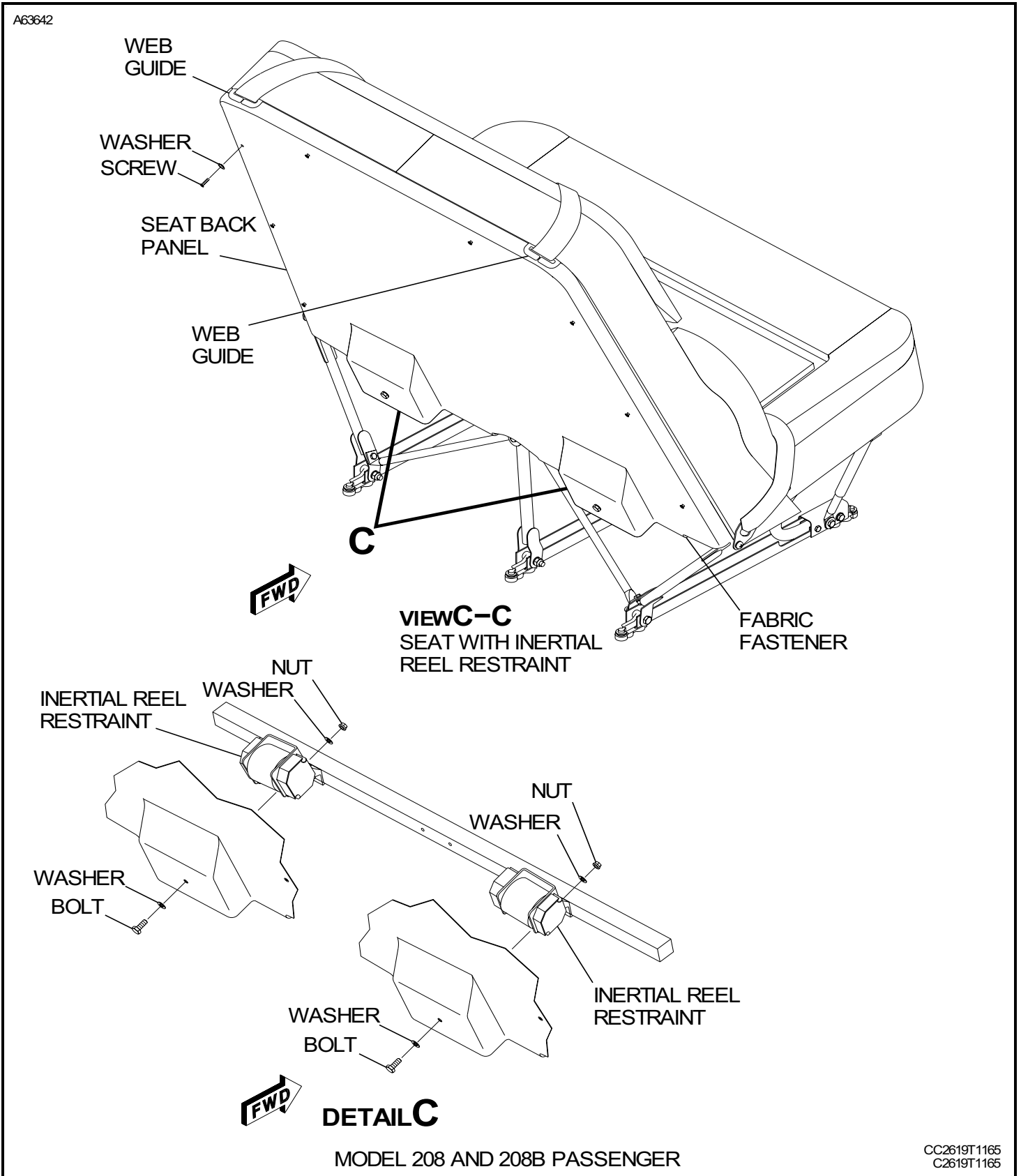
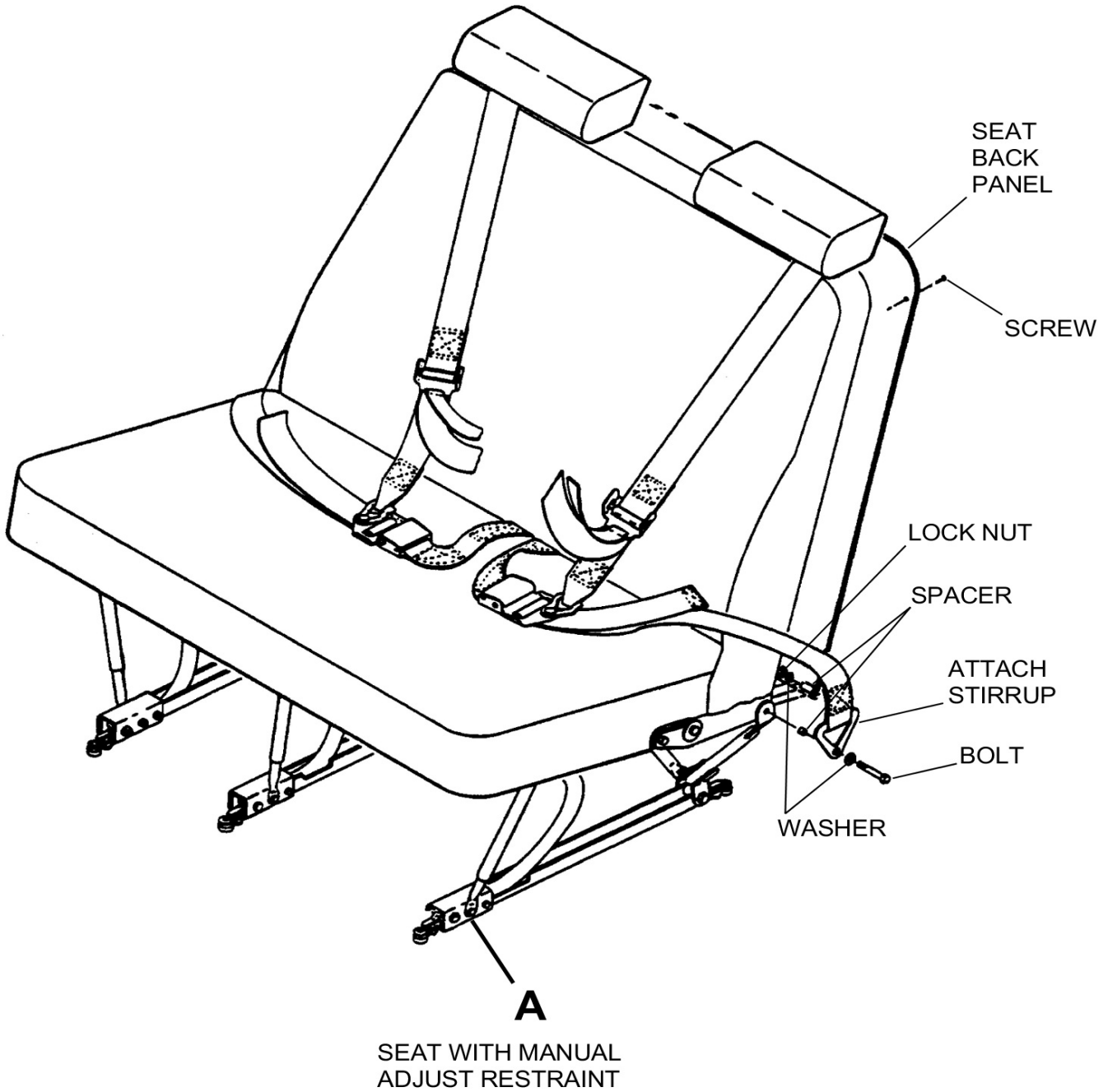

Figure 203 : Sheet 6 : Passenger Commuter Seat Installation

A22667



MODEL 208 AND 208B PASSENGER

2619R1102

Figure 204 : Sheet 1 : Optional Bench Seat Installation

A22671

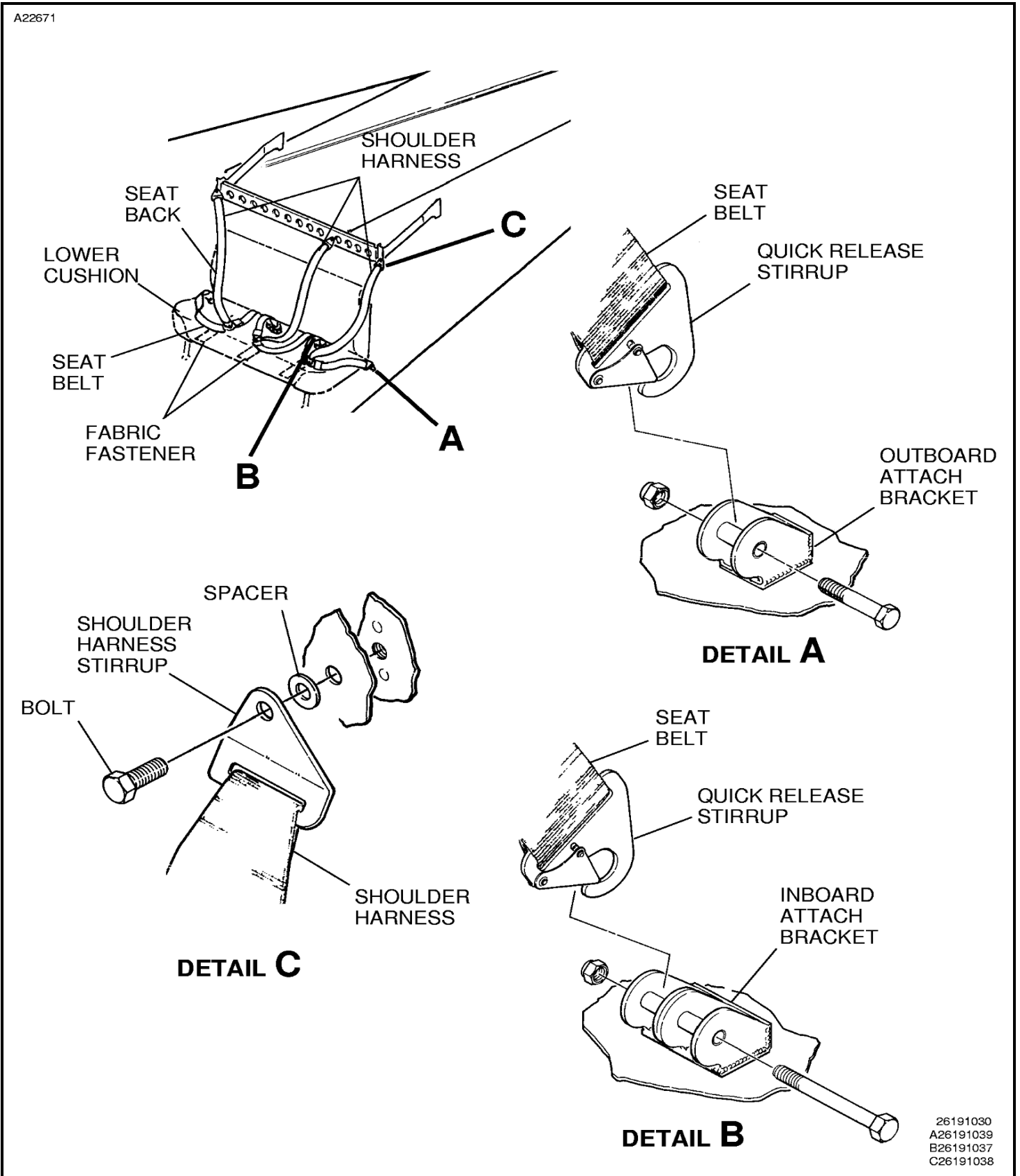
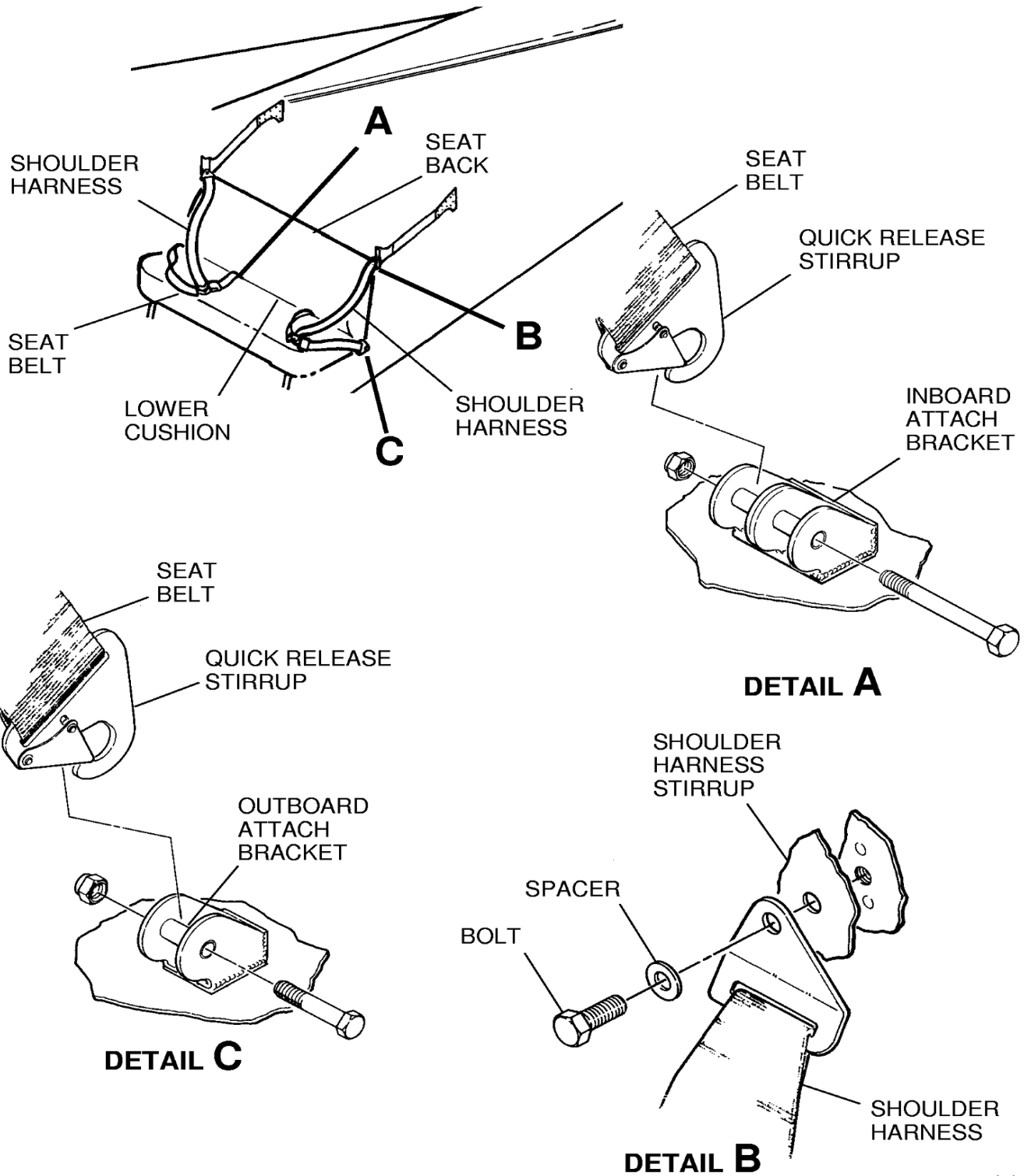

Figure 204 : Sheet 2 : Optional Bench Seat Installation

A22673



26191036A
A26191037
B26191038
C26191039